

## INSTALLATION INSTRUCTIONS

DESCRIPTION: Soft Side Cover

PART NUMBER: B4J-F17B0-V0

MODEL:2021+ Wolverine RMax4 and X4



### ⚠ WARNING

Please read and understand these instructions completely before installation to avoid possible injury, or damage to the accessory or vehicle.

- This weather enclosure is not intended to prevent injury during collisions or rollovers.
- Always wear a seat belt and a helmet when riding in this vehicle.

### NOTICE:

Installation of this kit requires a torque wrench and pop rivet gun. Installation should be performed by an authorized Yamaha dealer or a qualified technician. Do not tow the vehicle on an open trailer with this accessory installed, it is not designed for highway speeds.

### WARRANTY INFORMATION:

In the United States, see your Yamaha dealer for a copy of the Yamaha Genuine Parts and Accessories Limited Warranty.

### DEALER OR INSTALLER:

These instructions contain important information for future reference and *must* be given to the customer.

### PARTS LIST:

No.	Part Number	Description	Qty
--	<b>B4J-F17B0-V0</b>	Soft Side Cover	--
①	B4J-F1711-V0	Driver Side Cover	1
②	B4J-F1721-V0	Passenger Side Cover	1
③	B4J-F162F-V0	Male Snap	24
④	90267-32198	Blind Rivet	24
⑤	B4J-K7528-V0	M3 Nut	2
⑥	B4J-F2225-V0	Ring Holder	2
⑦	1XD-H1131-V0	Snap Lubricant	1
⑧	B4J-F15A2-V0	Front Strap (Attached to the ①+②)	2

\* Part supplied with kit only and not available separately.

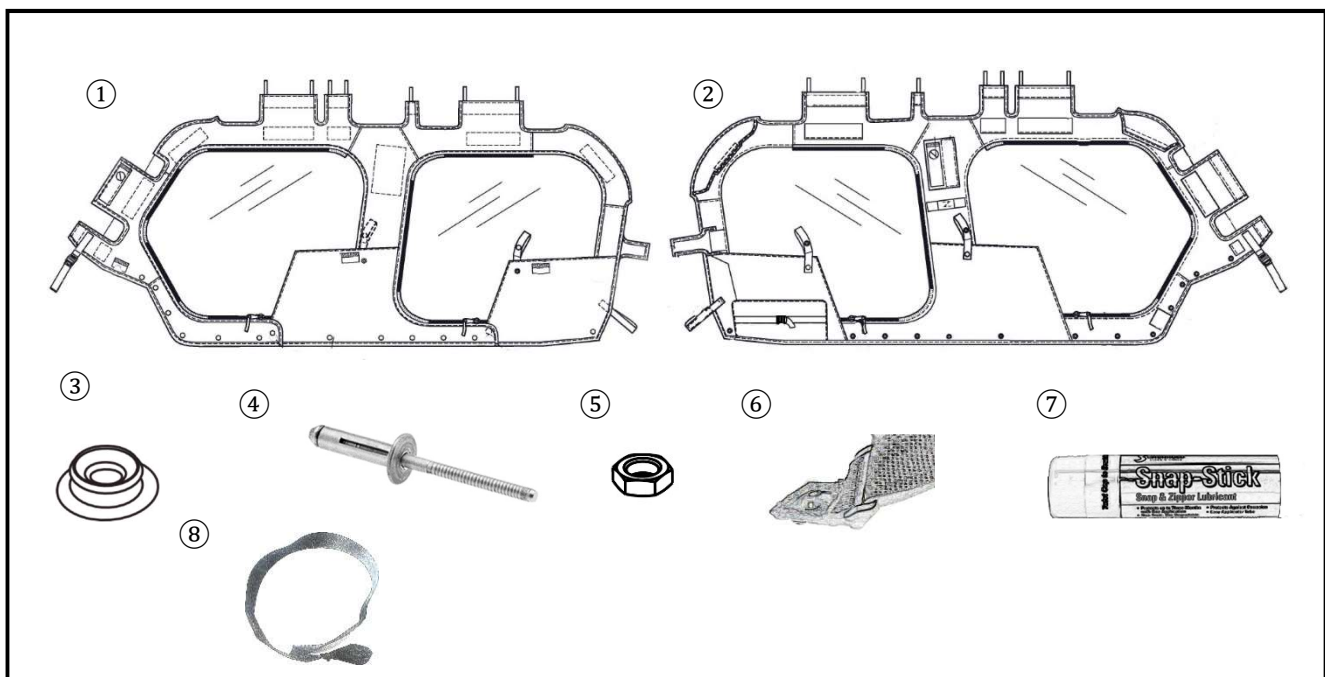

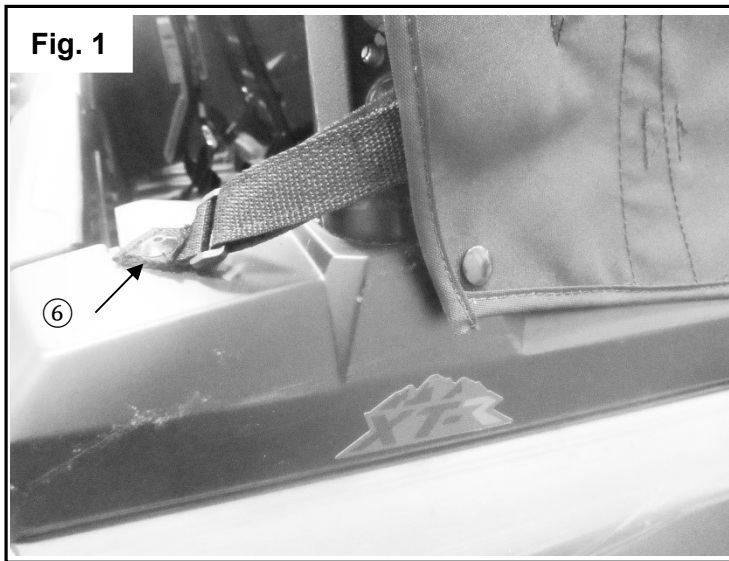

## PREPARATION:

- Place the vehicle on a secure and level surface.
- Set the parking brake.
- Clean the mounting surfaces before beginning installation.
- Soft Side Covers need to be installed before the Soft Rear Window.

## INSTALLATION:

1. Install the ⑥ Ring Holder to the rear of the vehicle using the existing fender bolt. Press the bolt through the webbing and thread it back into place. Torque to 5Nm (0.5 m-kg or 3.6 lb-ft) (Fig. 1)
2. Start on the left side. Wrap the hook and loop straps around the B Pillar to hold the ① Driver Side Cover to the vehicle. (Fig. 2)
3. Insert the wraps around the top ROPS and attach the hook and loop straps around the "C" pillar. Work forward and align the windows over the door openings. Remove the wrinkles and stretch the fabric front to back across the vehicle.
4. Remove the ⑧ Front Strap and loop it around the frame and route the ⑧ Front Strap up the "A" pillar. Reinstall the strap to the buckle on the front of the ① Driver Side Cover. (Fig. 3 and 4)
5. Route the inner strap around the bottom of the rear shoulder bolster and insert it in the buckle. Pull it tight. (Fig. 5)
6. Route the rear strap through the ⑥ Ring Holder and pull it tight. (Fig. 1)
7. Repeat the Steps 1 through 6 and attach the ② Passenger Side Cover to the other side of the vehicle.

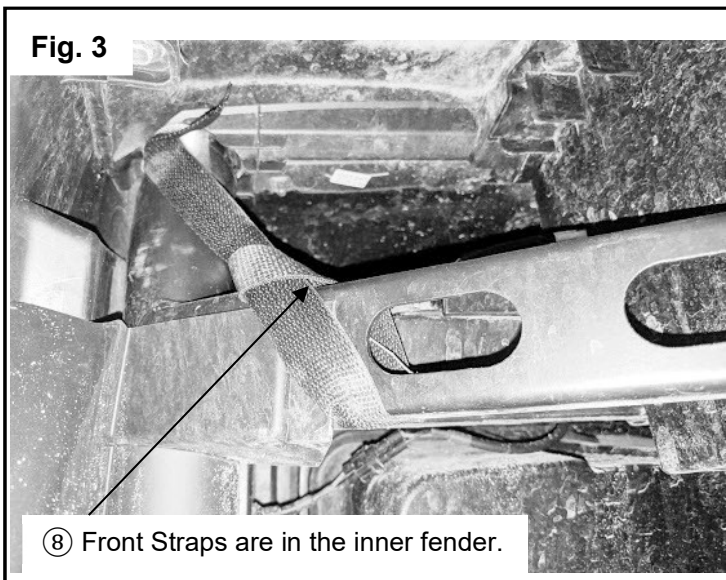
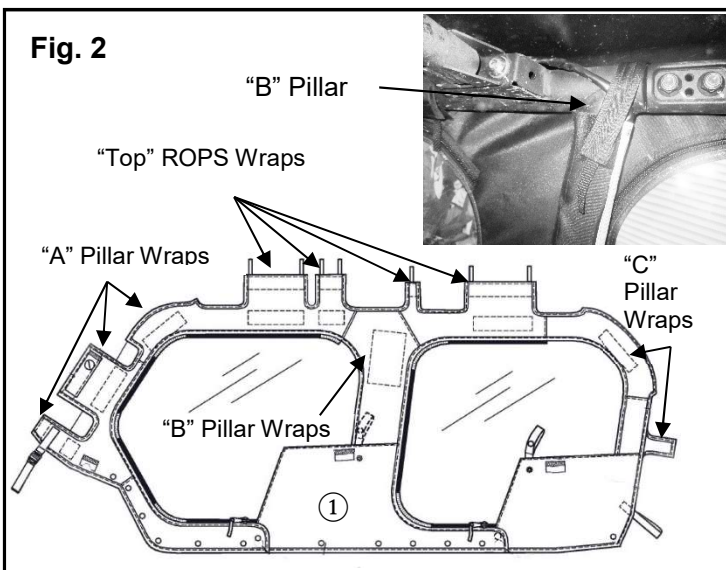

## How to Install Snaps with Rivets

1. Let the Side Covers hang. Zip all windows closed. During installation of the snaps, continue to ensure the fabric is taut and free of wrinkles before drilling and installing snaps.
2. Mark the snap locations and then drill out the holes used to mount the ③ Male Snaps using a 1/8" drill. Use a tape mark on the drill bit to set the drill depth at 1/2".
3. Use a pop rivet tool (not included in this kit) to install the ③ Male Snaps with ④ Blind Rivets. Follow these steps to install each rivet: (Fig. 7)
  - a. Insert ④ Blind Rivet into ③ Male Snap.
  - b. Place ⑤ M3 Nut on the ④ Blind Rivet.
  - c. Put ④ Blind Rivet into the body with the tool.
  - d. Pull the handle on the pop rivet tool to close the ④ Blind Rivet and

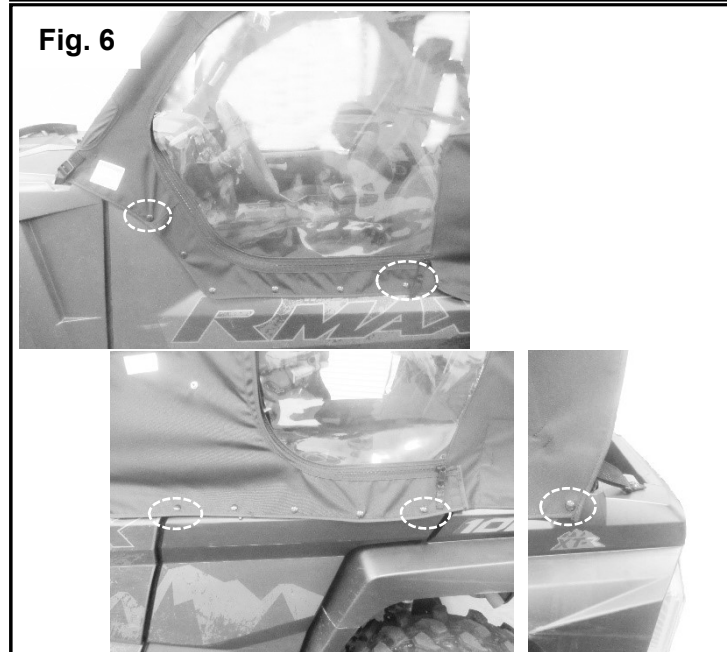
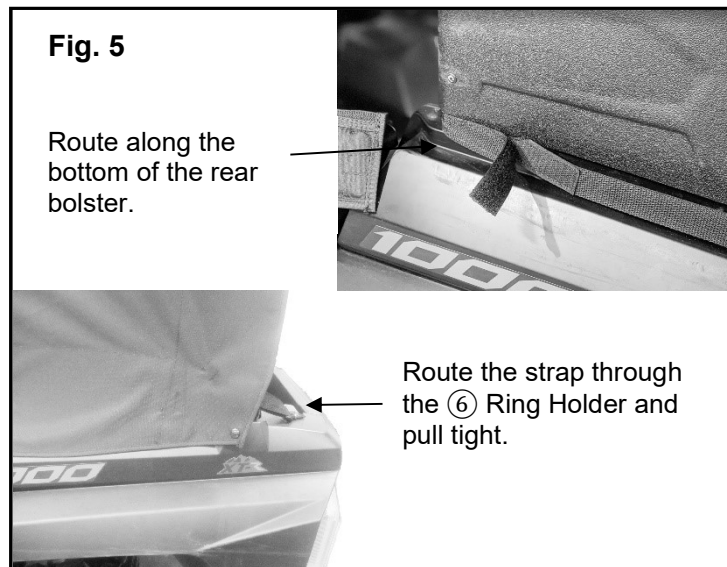
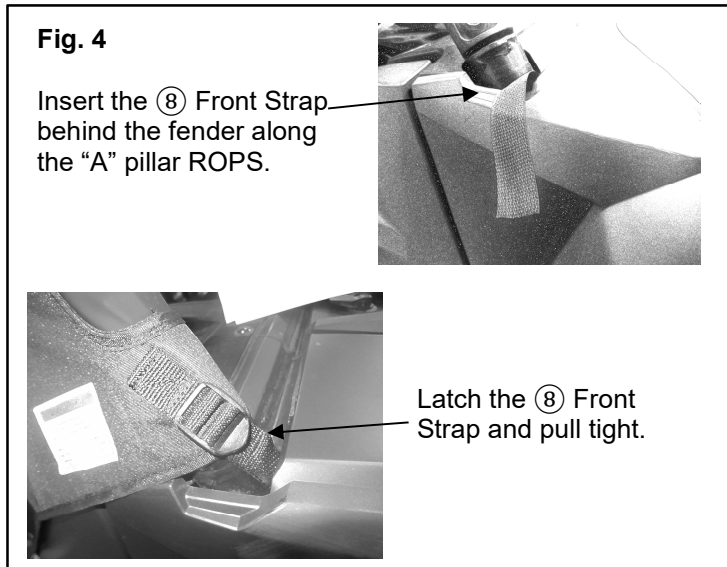

complete the installation of the ③ Male Snap.

4. Pull the side covers tight and attach the rest of the ③ Male Snaps on both sides of the vehicle. Continue to make sure the fabric is taut and free of wrinkles before installing any snaps.

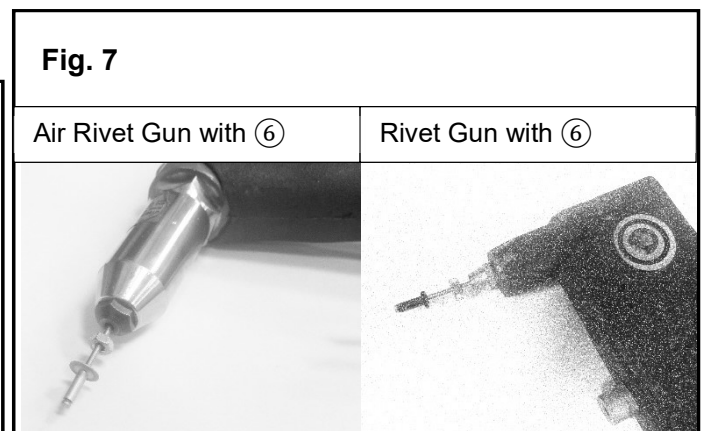

**MAINTENANCE:**

Periodically, check torque and tightness on hardware and straps. Re-torque or re-tighten any loose hardware. If zippers or snaps become hard to operate, apply Snap Lubricant to lubricate the side cover zippers and snaps.

**CARE AND CLEANING:**

Use a clean soft cloth and mild detergent with warm water to clean the side covers. Rinse and dry. Use Yamaha Windshield & Visor Plastic Cleaner & Conditioner (p/n ACC-PLASP-OL-11) to clean the plastic windows.

**CUSTOMER SERVICE:**

For further information see your Yamaha dealer.

**ESTIMATED TIME TO INSTALL: 1.2 HRS.**